

ST3 Shrink Tank

The ST3 is a fully automatic hot water shrink tank, designed for the production of ideal shrink packages from the hot water bath.

As a general rule, the ST3 is a component of the VC999 shrink line system, but it can also be integrated into packaging lines with external systems.



The ST3 shrink tank offers various variants for line integration in the inlet and outlet areas of the machine, as well as for control integration. The electrical version of the ST3 requires no compressed air and has an intuitive operator guidance on the touch screen display.

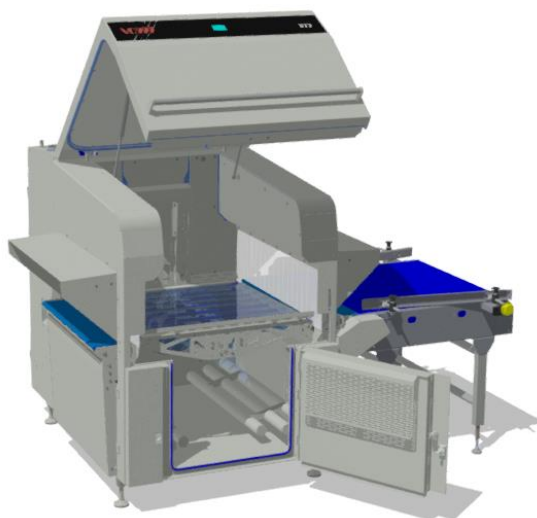

- consistent hygienic design in stainless steel and with FDA-compliant plastics
- Large cleaning opening through the tub door provides free access to the inside of the tub
- encapsulated heating pipes, high-pressure-capable process chamber design and optimised trough geometry for optimum flow characteristics guarantee cleaning without residues
- generous hood opening for max. access
- open immersion belt construction for cleaning when installed
- the plastic link belt of the dipping conveyor offers max. permeability and functional safety
- steam extraction on both sides outside the process chamber for optimised energy utilisation

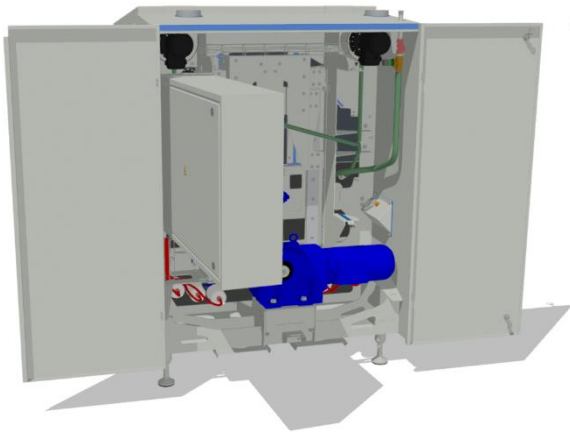

- programmable production preparation and automatic water bath regulation for efficient operation
- Non-contact level measurement for guaranteed, contamination-free operation
- alternative continuous operation
- Stand-by function for reduced operational readiness
- large usable area for dipping conveyor with 900 x 900 mm
- minimal machine dimensions with maximal power utilization
- swivelling control cabinet in the technical cabinet for accessibility during service and maintenance work

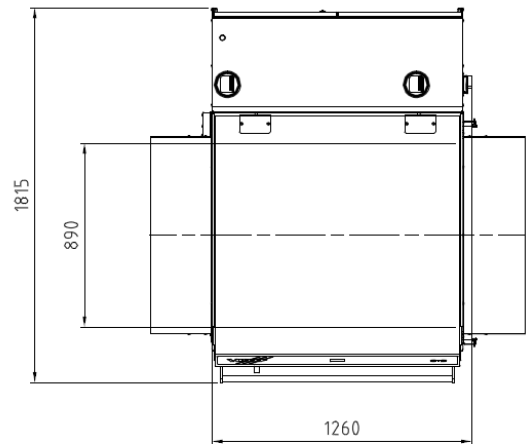
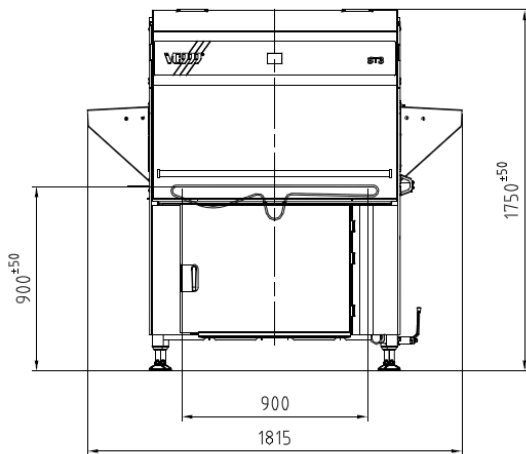

Technical Data

ST3

Dimensions (l x w x h)	1815 (1260) x 1815 x 1750	mm
Weight (without water)	1025	kg
Filling quantity water	500	litres
Electrical connection	400V / 50Hz / 53 kW / 80 AT	
max. product weight	75	kg
max. product height	250	mm
max. water bath temperature	95	°C
max. immersion cycles	6	Cycles/min
Dipping time	0 - 60	Sec.

Technical changes reserved